

PULL BAR

1. Drill holes.
2. Attach pull bar to door from the back with screws & washer.

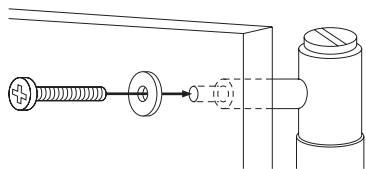

Contents

- 2x M5 x 30 mm screw*
- 2x Washer

*Fits doors & drawers of max 20 mm.

PULL BAR / PLATE

1. Drill holes.
2. Attach pull bar to door from the back with screws & washer.

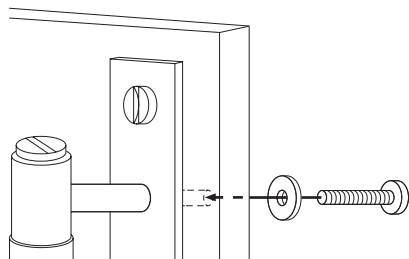

Contents

- 2x M5 x 30 mm screw*
- 2x Washer

*Fits doors & drawers of max 20 mm.



BUSTERANDPUNCH.COM

BUSTER + PUNCH

HARDWARE

PULL BAR

EUROPE INSTRUCTIONS

CARE INSTRUCTIONS

Use mild detergent and soft damp cloth

