

Gold Series Wall Pack 120w & 150w



DESCRIPTION:

Touch-Plate's Wall Pack Lights were designed to offer better security, more lumens, and higher cost savings. Our Wall Pack Lights can offer energy savings of 70% or greater over traditional metal halide or high pressure sodium lighting. Our LEDs are optimal for new construction and retrofit installation.

PRODUCT FEATURES:

- Heavy-duty aluminum housing
- No flickering or humming
- Eco-friendly, no mercury
- Lifetime of 50,000 hrs or greater
- DLC Listed
 - o WPXW120
- 5 Year Limited Warranty

SPECIFICATIONS:

- Wattage: 120w and 150w
- Lumens: 14,400 and 17,500 (approx > 120lm/w)
- Equivalence: 225w and 300w HID/HPS/MH
- CRI: >80Ra
- IP Rating: IP65
- LED Chips: SMD
- PF: >0.90

PHYSICAL PARAMETERS:

- Dimensions
 - o Length: 14.21"
 - o Height: 9.25"
 - o Depth: 7.7"
- Weight
 - o 12.13 lbs

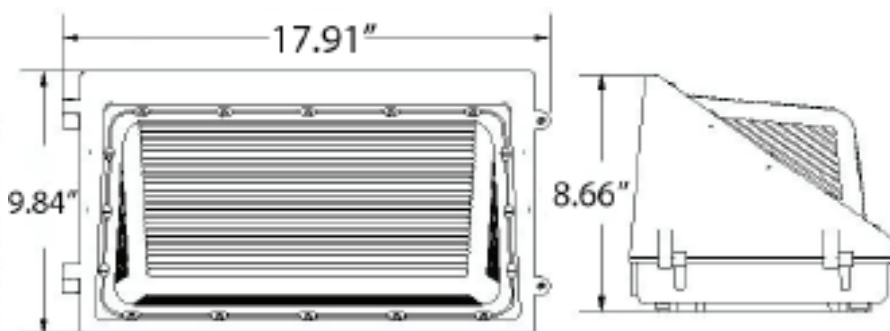



Gold Series Wall Pack

ORDERING GUIDE

LED Type XXX-	Lumens - Wattage XXX-XXX	CCT -XX	Voltage X	
<ul style="list-style-type: none"> WPK Wall Pack 	<ul style="list-style-type: none"> 144-120 14,400lm - 120w 175-150 17,500lm - 150w 	<ul style="list-style-type: none"> 35 3500k 40 4000k 50 5000k 57 5700k 	<ul style="list-style-type: none"> U 120-277v 	

ACCESSORIES

(specified at time of order)

- Photocell Control

PHOTOMETRIC

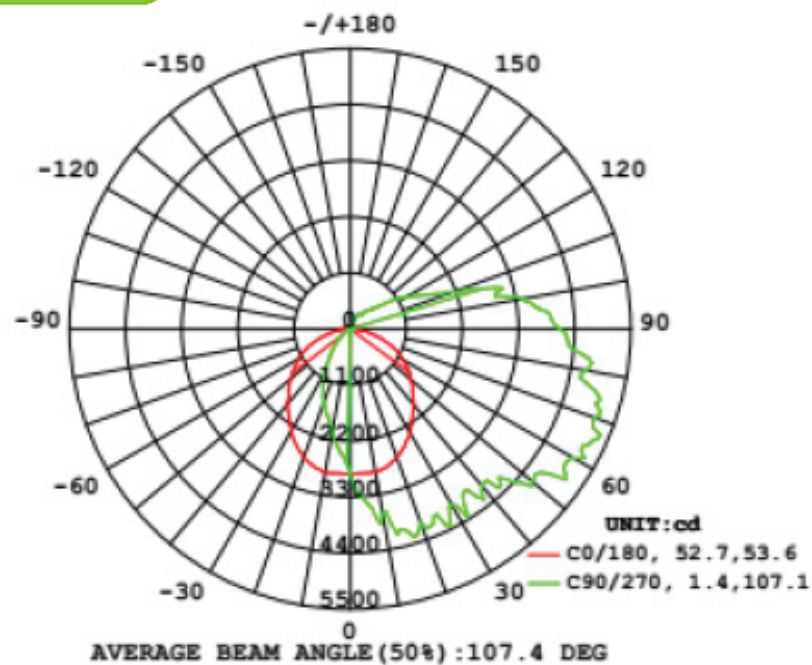

Gold Series Wall Pack

INSTALLATION INFORMATION (WIRING)

This product must be installed in accordance with National Electrical Code(NEC) and/or applicable local codes, by a qualified electrician.

DANGER - RISK OF SHOCK - DISCONNECT POWER BEFORE INSTALLATION

- Make the necessary 'HOT' (Black or Brown), 'Neutral' (White or Blue), and 'Ground' (Green) connections in an approved junction box.

INSTALLATION INFORMATION

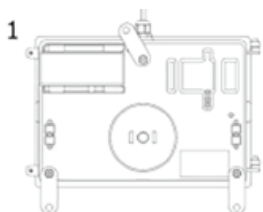

Rotate the 3 mountin brackets to the proper angle.

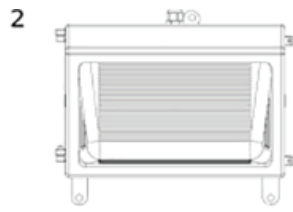

Hold the fixture to the wall making 3 marks according to the mounting brackets and drill holes for them.

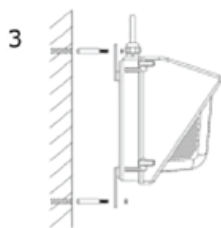

Push anchors into the holes. Match the mounting brackets to the anchors and attach the fixture to the wall with the screws provided.

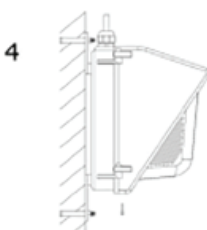

Connect the wires making sure there is good wire protection.



Take apart the PC cover and fixture housing

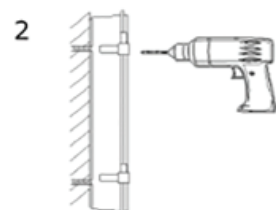

Hold the fixture firmly against the wall and drill 3 holes for the mounting brackets

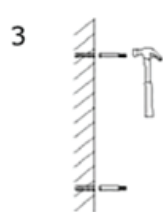

Push anchors into the holes. Line up the fixture to the wall with the holes and attach the fixture to the wall with the screws proved

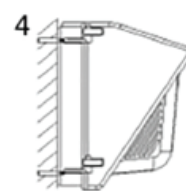

Put the PC cover and fixture housing back together.