

OEKA AD 2.1 AERODROME LOCATION INDICATOR AND NAME**OEKA - KHASHM ALAN/ Riyadh****OEKA AD 2.2 AERODROME GEOGRAPHICAL AND ADMINISTRATIVE DATA**

1	ARP coordinates and site at AD	243715N 0465507E/ 158°/0.57NM from THR 34
2	Direction and distance from (city)	271°, 11 NM from RIYADH
3	Elevation/Reference temperature	1848 FT/ 38°C
4	Geoid undulation at AD ELEV PSN	NIL
5	MAG VAR/Annual change	3°E (2016)/ 0.05 Increasing
6	AD Administration, address, telephone, telefax, telex, AFS	MINISTRY OF NATIONAL GAURD Riyadh Saudi Arabia TEL: +966 11 2905100 EXT 29031/28005
7	Types of traffic permitted (IFR/VFR)	VFR
8	Remarks	NIL

OEKA AD 2.3 OPERATIONAL HOURS

1	AD Administration	NIL
2	Customs and immigration	NIL
3	Health and sanitation	NIL
4	AIS Briefing Office	NIL
5	ATS Reporting Office (ARO)	NIL
6	MET Briefing Office	NIL
7	ATS	H24
8	Fuelling	04:00 - 11:00 UTC SAT
9	Handling	Limited / Sunshade
10	Security	H24
11	De-icing	NIL
12	Remarks	NIL

OEKA AD 2.4 HANDLING SERVICES AND FACILITIES

1	Cargo-handling facilities	NIL
2	Fuel/oil types	JET A/ MIL83262, MIL23699, MIL5606
3	Fuelling facilities/capacity	JET A/10000 liters
4	De-icing facilities	NIL
5	Hangar space for visiting aircraft	Limited / Sunshade
6	Repair facilities for visiting aircraft	Limited
7	Remarks	NIL

OEKA AD 2.5 PASSENGER FACILITIES

1	Hotels	NIL
2	Restaurants	NIL

3	Transportation	NIL
4	Medical facilities	NIL
5	Bank and Post Office	NIL
6	Tourist Office	NIL
7	Remarks	NIL

OEKA AD 2.6 RESCUE AND FIRE FIGHTING SERVICES

1	AD category for fire fighting	CAT B
2	Rescue equipment	E - one Titan 6x6.
3	Capability for removal of disabled aircraft	NONE
4	Remarks	NIL

OEKA AD 2.7 SEASONAL AVAILABILITY - CLEARING

1	Types of clearing equipment	NIL
2	Clearance priorities	NIL
3	Remarks	NIL

OEKA AD 2.8 APRONS, TAXIWAYS AND CHECK LOCATIONS/POSITIONS DATA

1	Apron surface and strength	Surface :Rigid and Flexible Strength:58/F/B/Y/T
2	Taxiway width, surface and strength	C : Width 23M, Surface Flexible and Strength:58/F/B/Y/T C1: Width 27.73M, Surface Flexible and Strength:58/F/B/Y/T C2: Width 34M, Surface Flexible and Strength:58/F/B/Y/T C3: Width 34M, Surface Flexible and Strength: 58/F/B/Y/T C4: Width 34M, Surface Flexible and Strength:58/F/B/Y/T C5: Width 28.44M, Surface Flexible and Strength:58/F/B/Y/T D : Width 28.5M, Surface Flexible and Strength:58/F/B/Y/T E : Width 34M, Surface Flexible and Strength:58/F/B/Y/T F : Width 34M, Surface Flexible and Strength:58/F/B/Y/T G : Width 23M, Surface Flexible and Strength:58/F/B/Y/T
3	Altimeter checkpoint location and elevation	NIL
4	VOR checkpoints	TWY C1, VOR checkpoints 243644.18N 0465526.33E TWY C5, VOR checkpoints 243747.82N 0465501.7E
5	INS checkpoints	NIL
6	Remarks	NIL

OEKA AD 2.9 SURFACE MOVEMENT GUIDANCE AND CONTROL SYSTEM AND MARKINGS

1	Use of aircraft stand ID signs, TWY guide lines and visual docking/parking guidance system of aircraft stands	Taxi guidance signs at all intersections with TWY and RWY and all holding positions.
2	RWY and TWY markings and LGT	RWY: Designation, THR, TDZ, CL, edge and appropriate, marked and lighted. TWY: Edge and CL lights, holding positions at all TWY/RWY intersections marked and lighted.
3	Stop bars	Stop bar where appropriate.
4	Remarks	NIL

OEKA AD 2.10 AERODROME OBSTACLES

In approach/TKOF areas			In circling area and at AD		Remarks
1			2		
RWY NR/Area affected	Obstacle type Elevation Markings/LGT	Coordinates	Obstacle type Elevation Markings/LGT	Coordinates	
a	b	c	a	b	

OEKA AD 2.11 METEOROLOGICAL INFORMATION PROVIDED

1	Associated MET Office	NIL
2	Hours of service MET Office outside hours	NIL
3	Office responsible for TAF preparation Periods of validity	NIL
4	Trend forecast Interval of issuance	NIL
5	Briefing/consultation provided	NIL
6	Flight documentation Language(s) used	NIL
7	Charts and other information available for briefing or consultation	NIL
8	Supplementary equipment available for providing information	NIL
9	ATS units provided with information	NIL
10	Additional information (limitation of service, etc.)	NIL

OEKA AD 2.12 RUNWAY PHYSICAL CHARACTERISTICS

Designations RWY NR	TRUE & MAG BRG	Dimensions of RWY(M)	Strength (PCN) and surface of RWY and SWY	THR coordinates RWY end coordinates THR geoid undulation	THR elevation and highest elevation of TDZ of precision APP RWY
1	2	3	4	5	6
34	340°GEO 337°MAG	2100 x 46	58/F/B/Y/T	243642.60N 0465519.07E	1 834.5FT
16	160°GEO 157°MAG	2100 x 46	58/F/B/Y/T	243746.94N 0465454.17E	1 848.2FT

Slope of RWY-SWY	SWY dimensions (M)	CWY dimensions (M)	Strip dimensions (M)	OFZ	Remarks
7	8	9	10	11	12
0.17% - 0.20%	91 x 46	300 x 150	2282.88 x 150	Available	The basic strip is provided only with a SWY
0.17% - 0.20%	91 x 46	300 x 150	2282.88 x 150		

OEKA AD 2.13 DECLARED DISTANCES

RWY Designator	TORA (M)	TODA (M)	ASDA (M)	LDA (M)	Remarks
1	2	3	4	5	6
34	2100	2400	2 191	2100	NIL
16	2100	2400	2 191	2100	NIL

OEKA AD 2.14 APPROACH AND RUNWAY LIGHTING

RWY Designator	APCH LGT type LEN INTST	THR LGT colour WBAR	VASIS (MEHT) PAPI	TDZ, LGT LEN	RWY Centre Line LGT Length, spacing, colour, INTST	RWY edge LGT LEN, spacing, colour INTST	RWY End LGT colour WBAR	SWY LGT LEN (M) colour	Remarks
1	2	3	4	5	6	7	8	9	10
34	PALS 300M LIH	green LIH	PAPI Left/ 3° 4 boxes	900 M white	2100 M, 15 M white	White / yellow. LIH	White / yellow. LIH	NIL	NIL
16	PALS 300M LIH	green LIH	PAPI Left/ 3° 4 boxes	900 M white	2100 M, 15 M. white	White / yellow. LIH	White / yellow. LIH	NIL	NIL

OEKA AD 2.15 OTHER LIGHTING, SECONDARY POWER SUPPLY

1	ABN/IBN location, characteristics and operational hours	NIL
2	LDI location and LGT Anemometer location and LGT	NIL
3	TWY edge and centre line lighting	Edge: All TWY Centre Line: All TWY
4	Secondary power supply/switch-over time	Yes/3.0 second
5	Remarks	NIL

OEKA AD 2.16 HELICOPTER LANDING AREA

1	Coordinates TLOF or THR of FATO Geoid undulation	OEKA H1 : 243701.27N 0465526.93E OEKA H2 : 243703.23N 0465532.96E OEKA H3 : 243736.94N 0465513.14E OEKA H4 : 243738.89N 0465519.15E OEKA H5 : 243743.87N 0465509.01E NIL
2	TLOF and/or FATO elevation M/FT	OEKA H1 : 561.92 M/ 1 843.53FT OEKA H2 : 562.66 M/ 1 845.98FT OEKA H3 : 564.16 M/ 1 850.88FT OEKA H4 : 565.28 M/ 1 854.58FT OEKA H5 : 563.50 M/ 1 848.72FT
3	TLOF and FATO area dimensions, surface, strength, marking	OEKA H1: 36 x 38M / rigid pavement OEKA H2: 36 x 38M / rigid pavement OEKA H3: 36 x 38M / rigid pavement OEKA H4: 36 x 38M / rigid pavement

4	True BRG of FATO	OEKA H1: 123° OEKA H2: 114° OEKA H3: 020° OEKA H4: 029°
5	Declared distance available	The length of the FATO.
6	APP and FATO lighting	APP and FATO lighting available.
7	Remarks	NIL

OEKA AD 2.17 ATS AIRSPACE

1	Designation and lateral limits	ATZ: Circle radius 3NM centered on ARP (243715N 0465507E)
2	Vertical limits	SFC to 3500 FT MSL
3	Airspace classification	G
4	ATS unit call sign Language(s)	KHASHM ALAN TWR English
5	Transition altitude	13000FT
6	Remarks	NIL

OEKA AD 2.18 ATS COMMUNICATION FACILITIES

Service designation	Call sign	Frequency	Hours of operation	Remarks
1	2	3	4	5
TWR	KHASHM ALAN TWR	122.875MHZ 249.825MHZ	HX HX	NIL NIL

OEKA AD 2.19 RADIO NAVIGATION AND LANDING AIDS

Type of aid, MAG VAR, CAT of ILS/MLS (For VOR/ILS/MLS, give declination)	ID	Frequency	Hours of operation	Position of transmitting antenna coordinates	Elevation of DME transmitting antenna	Remarks
1	2	3	4	5	6	7
VOR/DME	RAZ	114.2MHZ 98X	H24	243615.13N 0465531.95E	1900FT	NIL
LOC RWY 16 ILS CAT I	IMNG	111.7MHZ	H24	243757.41N 0465450.12E	1900FT	NIL
GP		333.5MHZ	H24	243653.79N 0465518.71E	1900FT	3° , RDH 57.2FT
DME	IMNG	54X	H24	243654.40N 0465518.57E	1900FT	NIL

OEKA AD 2.20 LOCAL TRAFFIC REGULATIONS

OEKA AD 2.21 NOISE ABATEMENT PROCEDURES

OEKA AD 2.22 FLIGHT PROCEDURES

OEKA AD 2.23 ADDITIONAL INFORMATION

OEKA AD 2.24 CHARTS RELATED TO AN AERODROME

Chart name

Page

Aerodrome chart - ICAO

AD 2-OEKA-7

INTENTIONALLY BLANK

AERODROME CHART - ICAO 24°37'15"N ELEV 1848 TWR: 122.875 249.825
046°55'07"E ATIS:
SMC: **KHASHM ALAN**

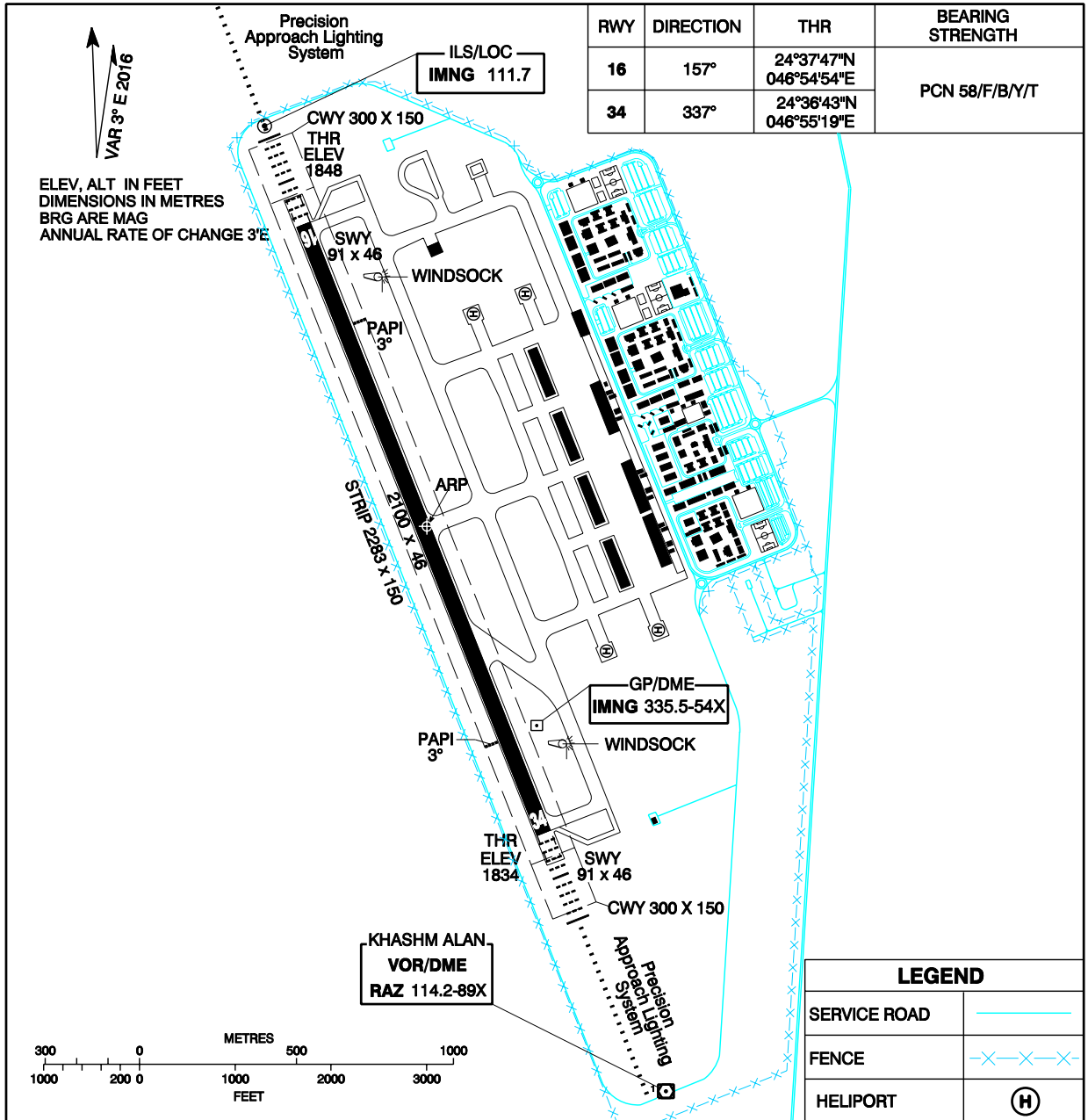

RWY	DIRECTION	THR	BEARING STRENGTH
16	157°	24°37'47"N 046°54'54"E	PCN 58/F/B/Y/T
34	337°	24°36'43"N 046°55'19"E	

ELEV, ALT IN FEET
DIMENSIONS IN METRES
BRG ARE MAG
ANNUAL RATE OF CHANGE 3'E

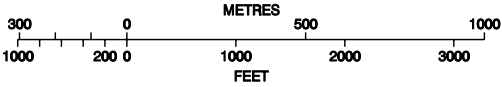

LEGEND	
SERVICE ROAD	—
FENCE	-X-X-X-X-
HELIPORT	(H)

Amdt: Original, 18 AUG 16 CHANGE: New Chart

DECLARED DISTANCES

RWY	TORA	TODA	ASDA	LDA
34	2100	2400	2191	2100
16	2100	2400	2191	2100

INTENTIONALLY BLANK