

Unit:mm

INSTALLATION MANUAL

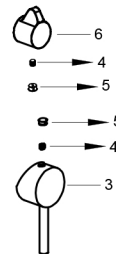

NO	name	QTY
1	Mixer Body	1
2	Face Plate	1
3	Handle	1
4	Button	2
5	Screw	2
6	Diverter	1
7		
8		
9		
10		
11		
12		
13		

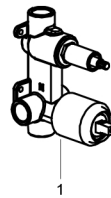
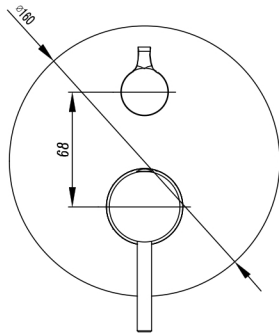
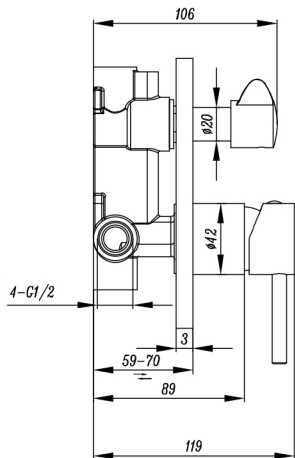
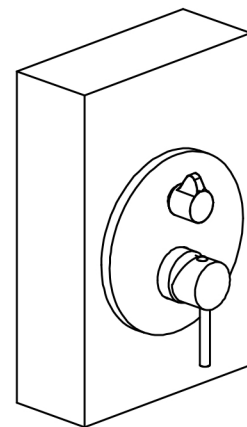
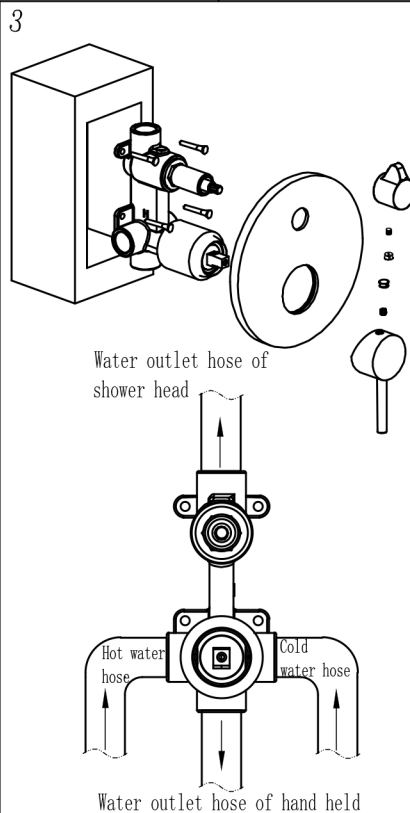
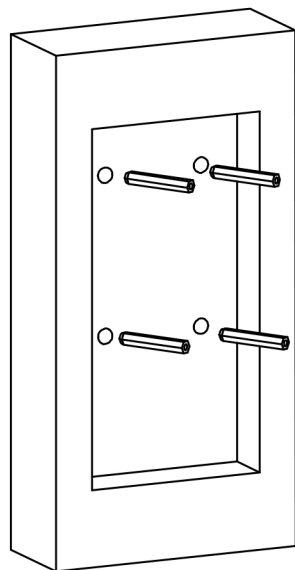

1.complete.

notes:

- 1.Workig pressure:0.05-1MPa
- 2.Working temperature:1 - 55°C
- 3.product is to be installed inaccordancewith AS/NZS3500.1
- 4.The flow controller incorporated in the outlet is tightenedto prevent removal by hand

- 1.Make a groove in the wall at a depth of 68mm, suggest depth is 68mm.
- 2.Find out the suitable position of the main body fixed hole in the groove,and then drill the hole to install the colloidal particles.

- 1Mount the mixer body into the wall, connect the body with the inlet and outlet pipes.
- 2.install the face plate onto the protective cylinder.
- 3.Put the fixing washer on the faceplate, install the diverter onto the mixer body and tighten with a spanner.
- 4.Install the handle on the cartridge and fix it up with screw.