

Silver Series Wall Pack 48w, 60w, 80w & 100w



DESCRIPTION:

Touch-Plate's Wall Pack Lights were designed to offer better security, more lumens, and higher cost savings. Our Wall Pack Lights can offer energy savings of 70% or greater over traditional metal halide or high pressure sodium lighting. Our LEDs are optimal for new construction and retrofit installation.

PRODUCT FEATURES:

- Heavy-duty aluminum housing
- No flickering or humming
- Eco-friendly, no mercury
- Lifetime of 50,000 hrs or greater
- DLC Listed
 - ML-WPB-48w
 - ML-WPB-60w
 - ML-WPB-80w
 - ML-WPB-100w
- 5 Year Limited Warranty

SPECIFICATIONS:

- Wattage: 48w, 60w, 80w, and 100w
- Lumens: 5,300, 6,600, 8,800, and 11,000 (approx > 110lm/w)
- Equivalence: 125w, 140w, 190w and 225w HID/HPS/MH
- CRI: >80Ra
- IP Rating: IP65
- LED Chips: SMD
- PF: >0.90

PHYSICAL PARAMETERS:

- Dimensions
 - Length: 14.21"
 - Height: 9.25"
 - Depth: 7.7"
- Weight
 - 12.13 lbs

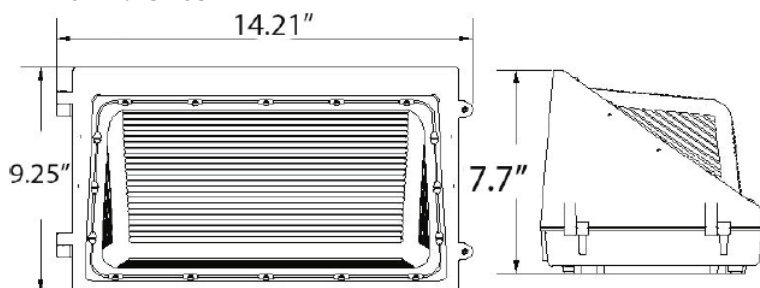



Silver Series Wall Pack

ORDERING GUIDE

LED Type XXX -	Lumens - Wattage XXX - XXX	CCT XX -	Voltage X	
<ul style="list-style-type: none"> WPK Wall Pack 	<ul style="list-style-type: none"> 053-048 5,300lm -48w 066-060 6,600lm-60w 088-080 8,800lm-80w 110-100 11,000lm-100w 	<ul style="list-style-type: none"> 35 3500k 40 4000k 50 5000k 57 5700k 	<ul style="list-style-type: none"> U 120-277v 	

ACCESSORIES

(specified at time of order)

- PhotoUW^5a` fda^

PHOTOMETRIC

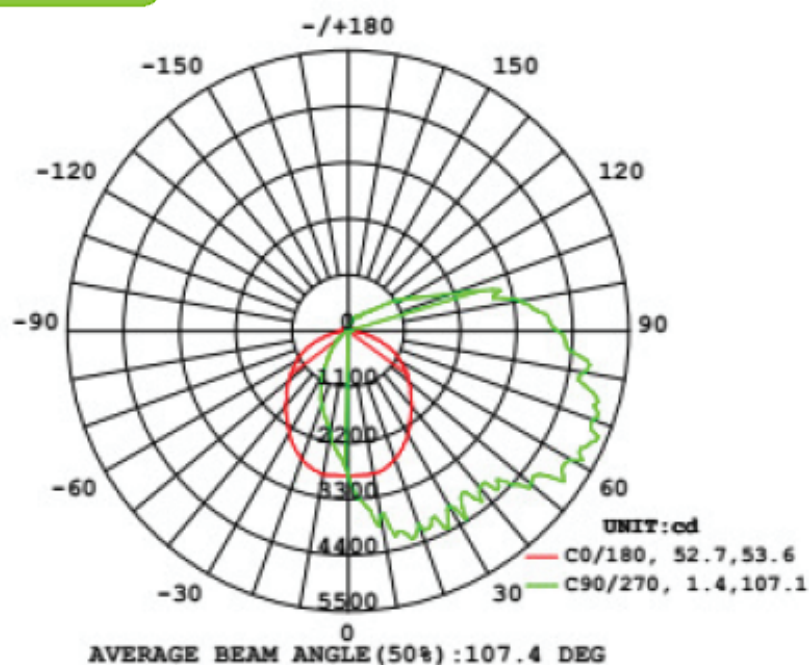

Silver Series Wall Pack

INSTALLATION INFORMATION (WIRING)

This product must be installed in accordance with National Electrical Code(NEC) and/or applicable local codes, by a qualified electrician.

DANGER - RISK OF SHOCK - DISCONNECT POWER BEFORE INSTALLATION

Wall Packs can be ordered with a specified twist lock plug or without a plug.

Plug in the Wall Pack or make the necessary 'HOT' (Black or Brown), 'Neutral' (White or Blue), and 'Ground' (Green) connections in an approved junction box.

INSTALLATION INFORMATION

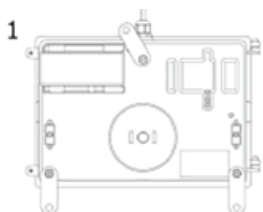

Rotate the 3 mountin brackets to the proper angle.

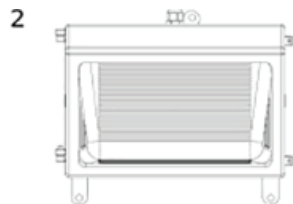

Hold the fixture to the wall making 3 marks according to the mounting brackets and drill holes for them.

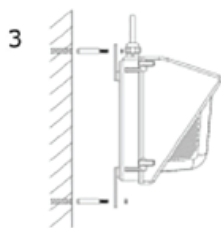

Push anchors into the holes. Match the mounting brackets to the anchors and attach the fixture to the wall with the screws provided.

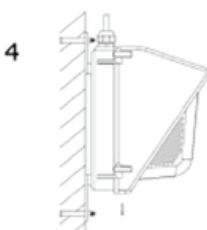

Connect the wires making sure there is good wire protection.



Take apart the PC cover and fixture housing

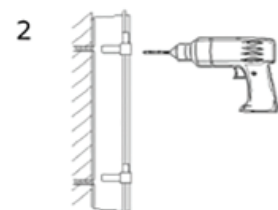

Hold the fixture firmly against the wall and drill 3 holes for the mounting brackets

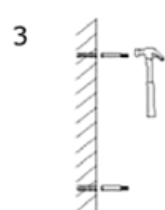

Push anchors into the holes. Line up the fixture to the wall with the holes and attach the fixture to the wall with the screws proved

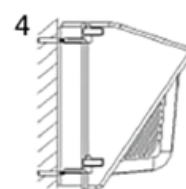

Put the PC cover and fixture housing back together.