



BUSTER + PUNCH

HEAVY METAL
INSTRUCTION MANUAL
EUROPE

BUSTERANDPUNCH.COM

SAFETY & INSTALLATION

These instructions are provided for your safety. It is vitally important that they are read in their entirety before commencing installation of your fitting.

1. Consult a qualified electrician as to the installation of the fitting. Install in accordance with current IEE wiring regulations.
2. Ensure that the electricity supply is OFF. Disconnect the electrical supply at the fuse-board.
3. If removing an existing fitting first, note all wiring connections: record which of the house wires is connected to the live, neutral & earth terminals.
4. Carefully identify where the supply cable is (and check there are no other cables in the area) to avoid damage to connected wiring during installation.
5. Position the light where desired ensuring that there is a suitable support adjacent to where you will connect to the house supply.
6. Determine the fixing method appropriate to the ceiling construction.
7. Prepare ceiling by marking and then drilling the fixing holes.
8. Support the fitting so that no strain is applied to the wiring when making the electrical connections, if necessary get a colleague to help.
9. Connect the live conductor of your main supply to the terminal marked "L". Connect the neutral conductor of your main supply to the terminal marked "N". Connect the earth conductor of your main supply to the terminal marked "E".
10. Ensure that all electrical connections are tight and no wires are trapped behind or within the fitting and complete the installation.
11. Fit the correct type and wattage of bulb.
12. Switch on at the fuse-board. Your light is now ready to use.

OTHER IMPORTANT INFORMATION

Switch off at mains before changing the light bulbs or cleaning. Never fit a bulb of greater wattage than recommended. Children should be discouraged from playing with light fittings. Dispose of old bulbs carefully. Never leave a fitting without a bulb in position (or someone can accidentally touch the contacts). Do not mount on a damp surface such as newly painted or plastered areas as this may cause discoloration of the finish. Clean with a soft dry cloth. Do not use water or abrasive materials when cleaning. Retain for future reference.

RECYCLING ELECTRICAL PRODUCTS

Buster and Punch encourages all of its customers to make note of this symbol and avoid putting any waste electrical goods in your domestic waste bin or container. Please ensure you take your waste electrical goods to a suitable facility for disposal.

220-240V – 50/60HZ
MAX 40W, E27 SCREW BULB



IP20



INSTALLATION

Before commencing work, isolate the mains power supply and remove the fuse in the fuse box or switch off the circuit breaker in the consumer unit.

1.

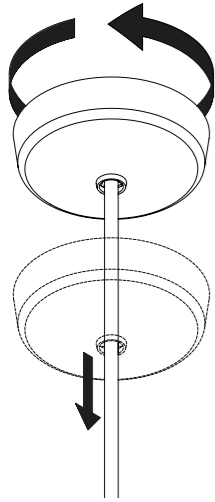

1. Unscrew the supplied ceiling rose cover and slide it down the cable.

2.

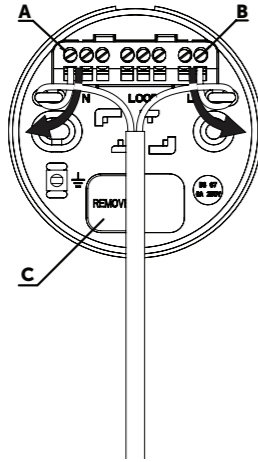

2. Disconnect the pendant cable connections **A** & **B** from the terminal block as shown in diagram. Remove panel **C** if insufficient space for cables to pass through the ceiling rose in step 3.

3.

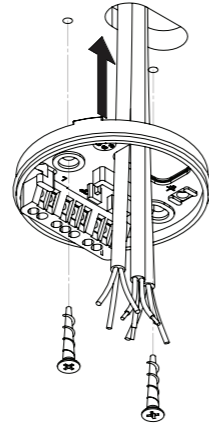

3. Pass the supplied ceiling cable rose over the existing cables in the ceiling. Secure the supplied ceiling rose base to the ceiling using appropriate screws. Do not over-tighten fixing screws.

4.

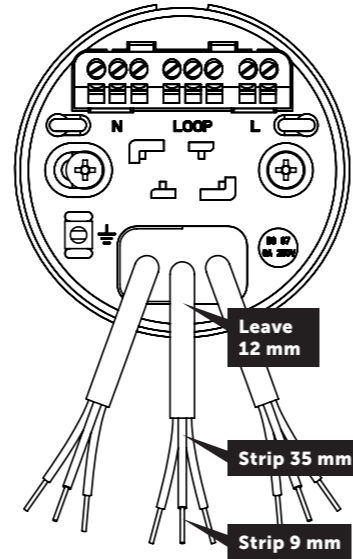

4. Strip 35 mm of outer insulation from the mains cable, leaving about 12 mm of the outer insulation within the base. Strip 9 mm of inner insulation from the red or brown and black or blue wires.

5.

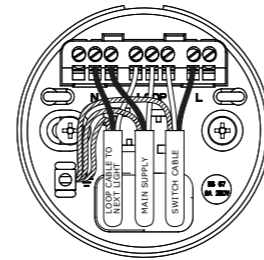

— red or brown
— black or blue
— green/yellow

5. For a typical lighting circuit connect as per the diagram shown. Fit green/yellow sleeving to the bare earth terminal block. Ensure all terminals are properly tightened and no bare wires are visible. Ensure conductors will not be trapped once the cover is replaced.

6.

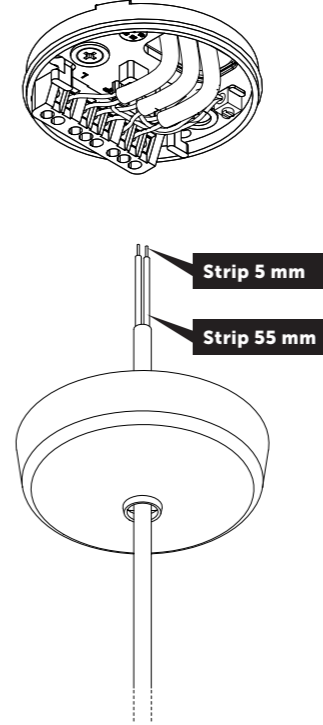

6. Cut the pendant flex (which you disconnected from the terminal block) down the desired length. From the same end, strip 55 mm from the outer insulation. From the same end, strip 5 mm from the inner insulation.

7.

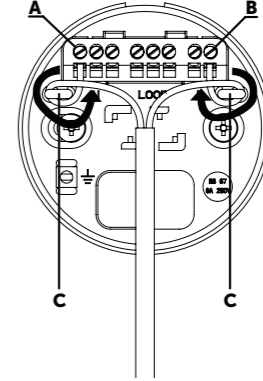

Previous connections made in stage 5 not shown.

7. Screw the blue 'Neutral' wire into **A**. Screw the brown 'Live' wire into **B**. Ensure you pass the brown and blue wires above and around the strain relief bars **C**, as per the diagram, before fitting the cover.

8.

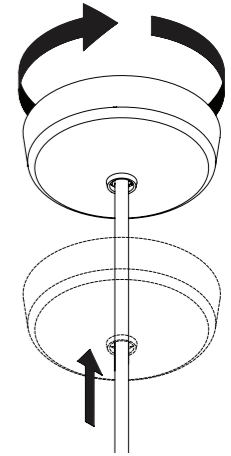

8. Replace the cover carefully, ensuring no wires are trapped and no inner brown or blue wire insulations are exposed outside the ceiling rose cover, once the cover is fully screwed back into place.