

# RVH9333

APRON-FRONT WORKSTATION SINK

**RUVATI**<sup>®</sup>  
SPECIFICATION SHEET

## MATERIAL

True 16 Gauge Thickness  
Premium T304 Grade Stainless Steel  
18/10 Chromium/Nickel Content  
Commercial Brushed Finish

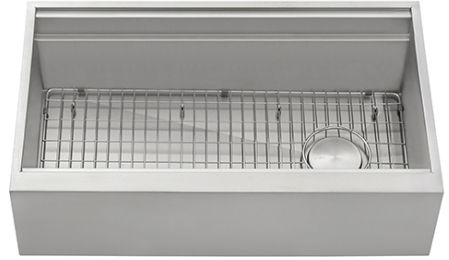

## FEATURES

- Heavy duty sound guard padding and undercoating
- Slanted bottom with elegant drain grooves for easy draining
- Dual-Tier Ledge for Accessories



## IN THE BOX

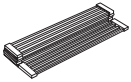

Folding Rack  
[RVA1395]

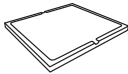

Cutting Board  
[RVA1233]



Mixing Bowl and Platform  
[RVA1288]

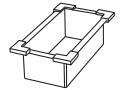

Collander  
[RVA1310]



Basket Strainer  
[RVA1025]



Drain Cover  
[RVA1035]



Condiment  
Serving Tray  
[RVA1377]

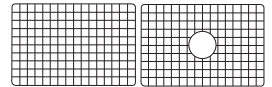

Rinse Grid  
[RVA68333]

## NOMINAL DIMENSIONS

Exterior: 45" (wide) x 20-1/8" (front-to-back)  
Interior Bowl: 43-3/8" (wide) x 16" (front-to-back)  
Bowl Depth: 10"  
Minimum Cabinet Size: 48" wide  
Drain Hole Size: 3 1/2"

Installation Type:  
Apron-Front

Inside Corners:  
Zero Radius

Drain Location:  
Offset

**RUVATI USA**

www.ruvati.com

Phone: 1.855.478.8284  
Email: support@ruvati.com

## OPTIONAL ACCESSORIES (SOLD SEPARATELY)



Deep Basket  
Disposal Flange  
[RVA1049ST]

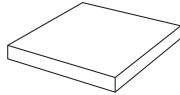

Butcher Block  
[RVA2445ACA]

## DIMENSIONS

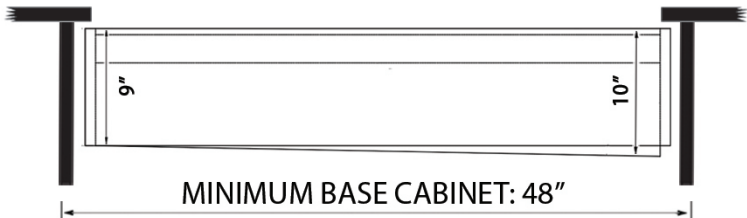
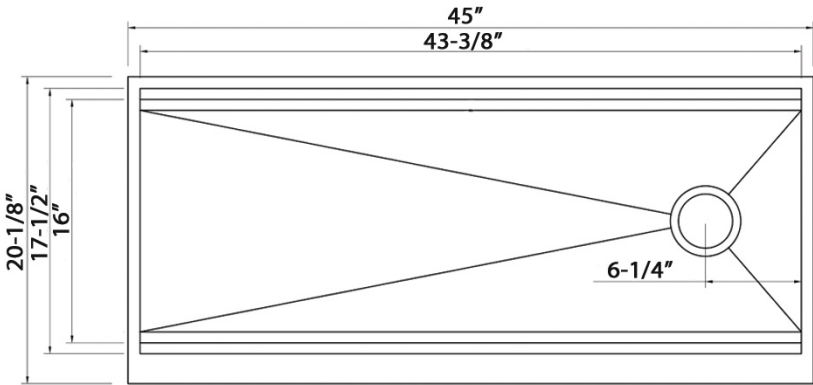

Register your product at [www.ruvati.com/register](http://www.ruvati.com/register).